

Checkball Springs

119940-20

10 Checkball Springs

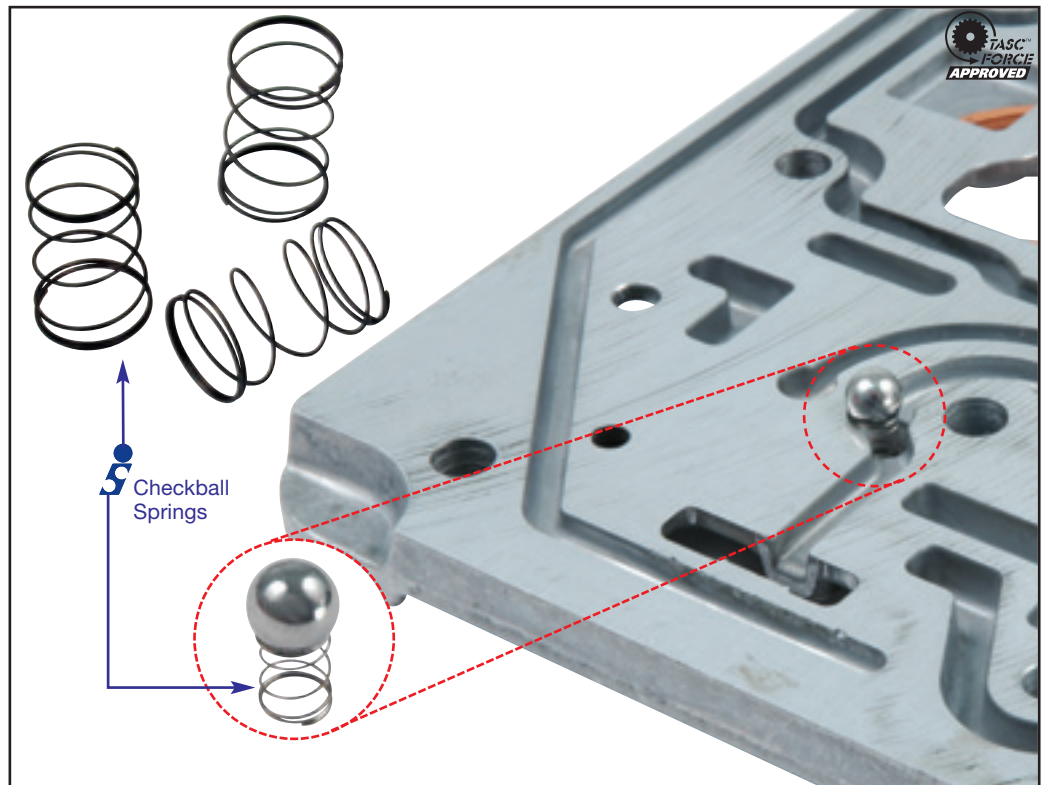

INSTRUCTIONS

1. Remove and discard OEM spring.
2. Install new spring and OEM checkball in indicated pocket.

Note: Some of the Phase 0 and 1 valve bodies (096, 097, 098) also contain this checkball spring. This replacement spring may be used in those applications after the location and spring specifications are verified. The OEM spring should measure .008" wire diameter, .178"/.194" outside diameter, and approximately .280" long in order to use this replacement spring.