

Boost Valve & Sleeve Kits

37947-01K OEM Ratio

37947-03K Increased Ratio

Each kit includes the following

- 1 Boost Valve
- 1 Boost Sleeve

Note: OEM sleeves may come in either a 3- or 2-circuit design. Boost valve kits **37947-01K** and **-03K** may be used to replace either version.

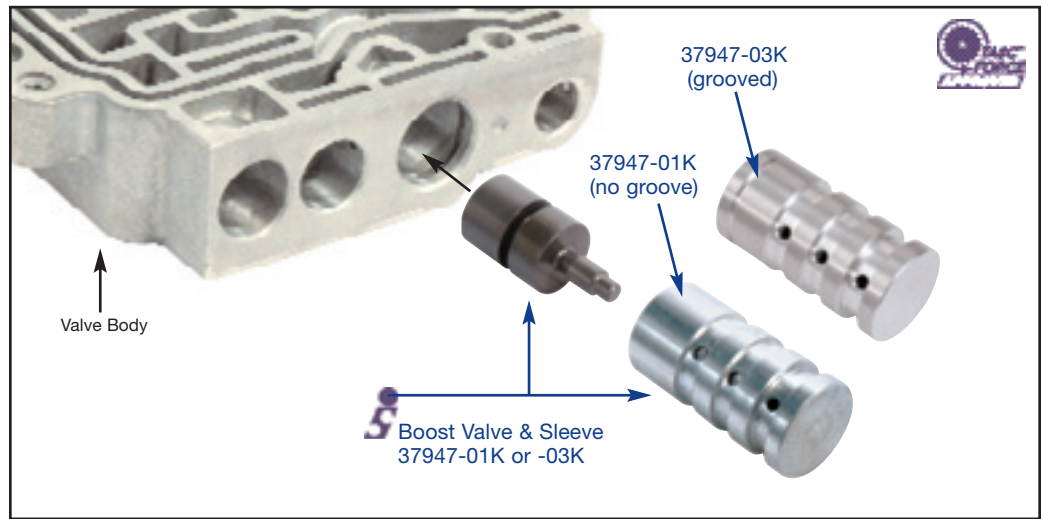

Wet Air Test (Valve Removed)

Perform a Wet Air Test to determine if the original boost valve assembly is worn and must be replaced. With the boost assembly removed from the valve body, place a small amount of oil into the bottom of the boost sleeve. Reinsert the boost valve. Blow low air pressure into the cutback boost sleeve orifice while securely holding down the boost valve. If air/oil leaks from the modulated TV or reverse orifices or from the end of the sleeve, there is excessive wear and the assembly should be replaced.

Wet Air Test (Valve Installed)

To Wet Air Test with the boost valve assembly still in the valve body and the plate still on, place a small amount of oil into the modulated TV orifice. Follow with low air pressure. There should be minimal leakage through the cutback and reverse separator plate ports.

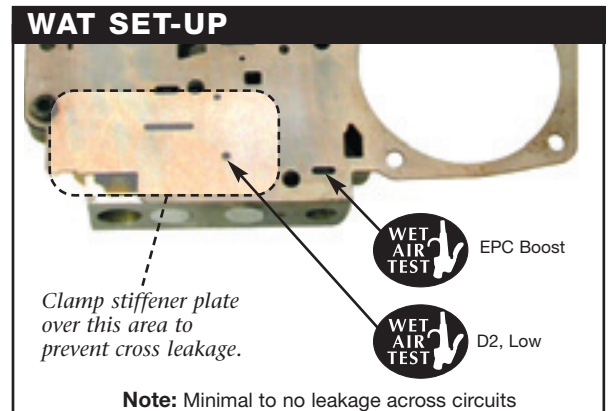

Installation Instructions

Remove the worn boost valve and sleeve from the valve body. Replace with the Sonnax boost valve kit. Refer to the line-up below to ensure all parts are returned in the proper order and correct orientation.

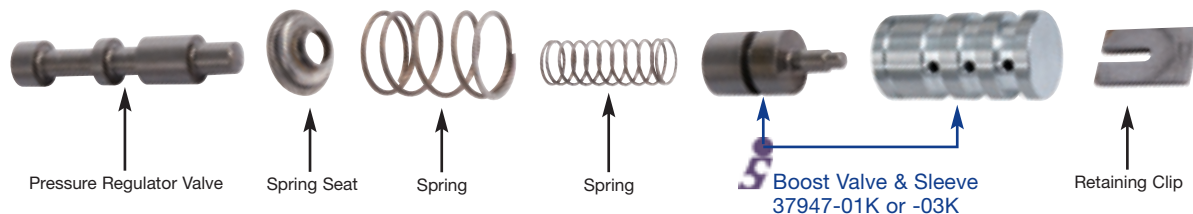

Pressure Comparison Between OEM and Increased Ratio Boost Valves

EPC PSI	37947-01K (OEM Ratio)		37947-03K (Increased Ratio)	
	Line	Reverse	Line	Reverse
30	107	135	114	143
75	178	224	194	243
120	250	313	275	343

